

# Installation Lever and Cylinder



Remove the upper and lower allen screws on the hinge-side of the panic with a **Y33 allen wrench**.



Continued from **STEP 1**.



Use caution when sliding the panic bar to expose the lock mechanism. **The panic button will pop out.**

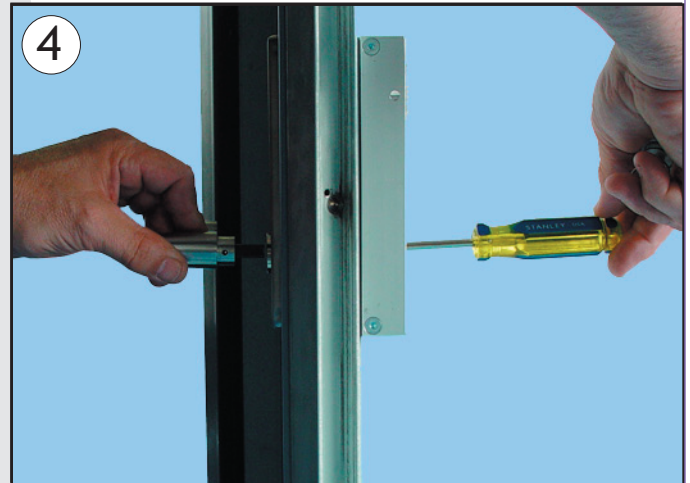

Insert lever handle as shown.



Secure the handle by tightening the phillip screw located inside the lock body.



**Total Door** SYSTEMS  
Global Leader in Integrated Access Technology™

# Installation Lever and Cylinder

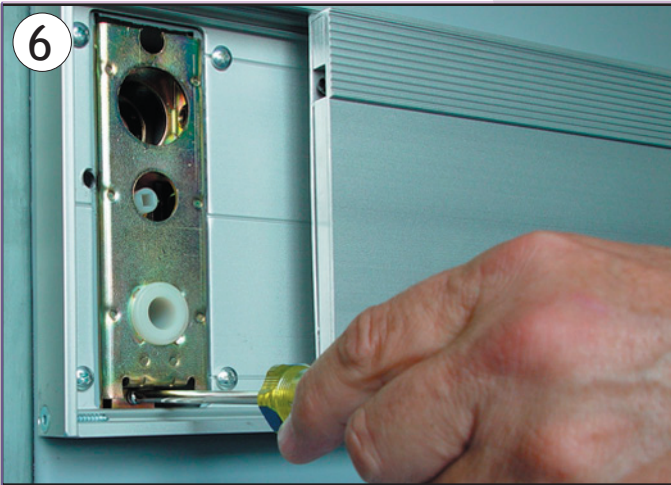

To install the cylinder, loosen the bottom phillips screw **3 TURNS**.



Loosen the set screws to install your cylinder.



Loosen the top phillips screw **6 TURNS**.



Screw in the cylinder which should have a standard **B Cam**.



The lock should loosen enough to access the cylinder set screws as shown in **STEPS 8 & 9**.



**Total Door** SYSTEMS  
Global Leader in Integrated Access Technology™

# Installation Lever and Cylinder



Tighten the allen set screws on both sides of the lock.

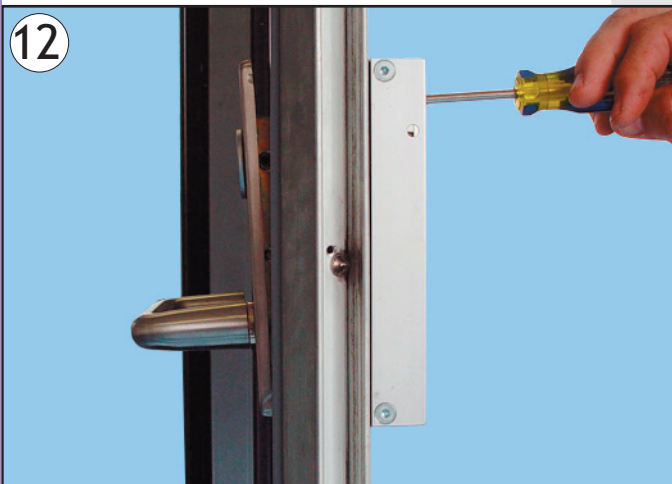

Tighten the top screw of the lock.

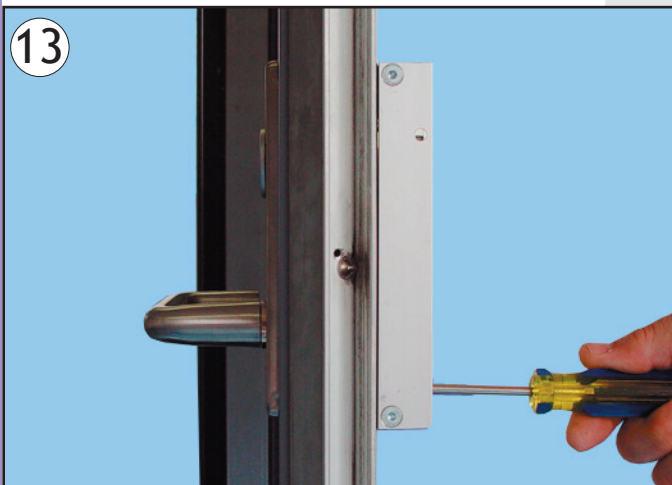

Tighten the bottom screw of the lock.



Insert the panic button as shown in inset picture. Slide the bar over.

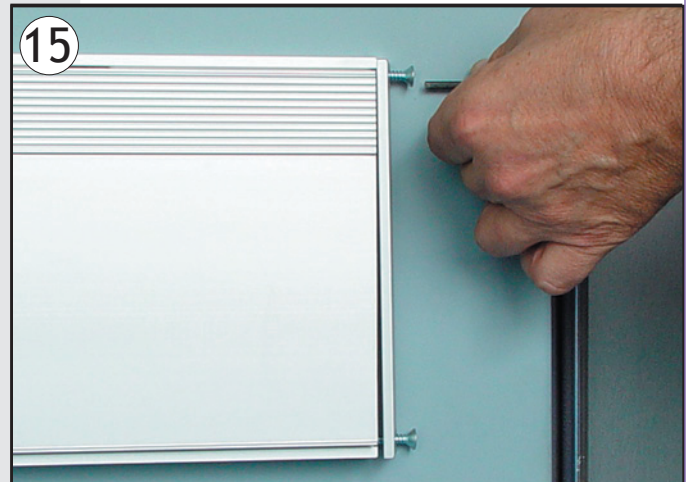

Reinstall end caps and screws.