

## PACKAGING STANDARDS

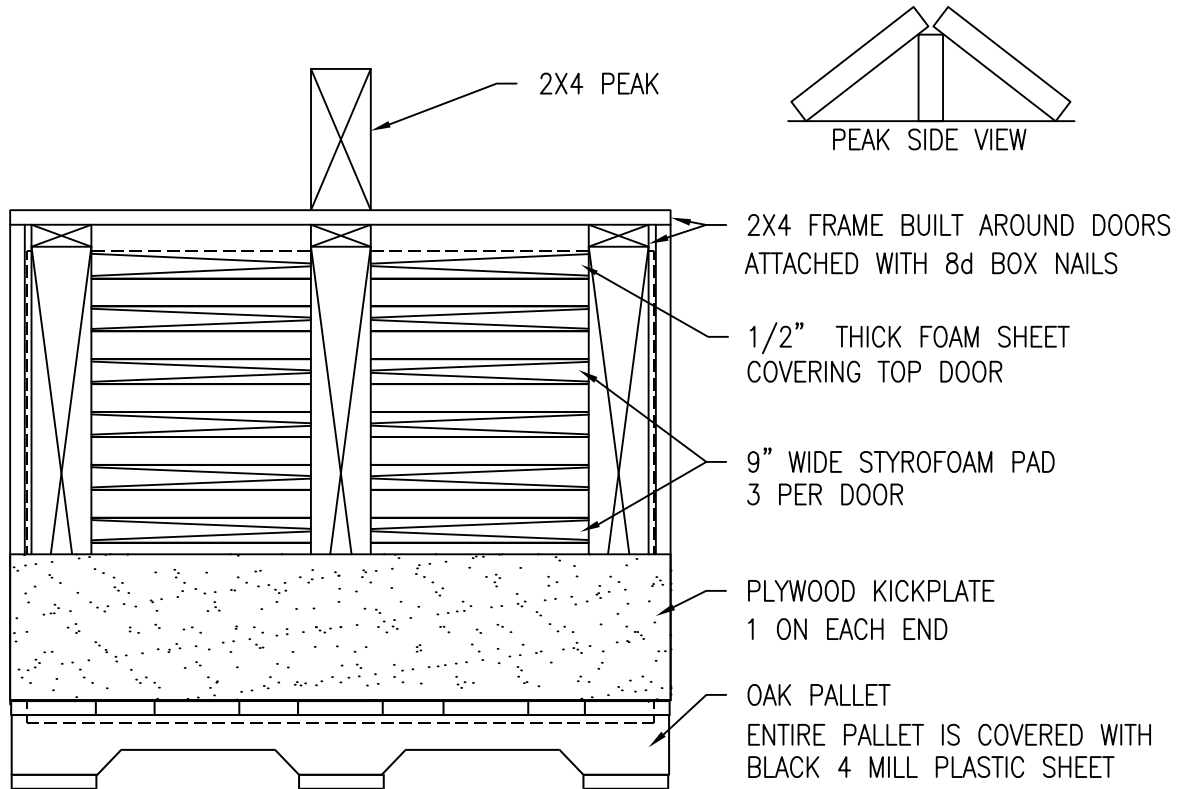

- A) UP TO 12 DOORS ARE PACKED PER PALLET. (DEPENDING ON HARDWARE).
- B) ALL GRIPS AND MECHANISMS ARE INSTALLED (LEVERS ARE NOT INSTALLED).
- C) WHENEVER ANY OF THE FOLLOWING ITEMS ARE ORDERED, THEY ARE AUTOMATICALLY INSTALLED BY TOTAL DOOR SYSTEMS:

PANIC EXIT DEVICES, LITES, LOUVERS, GLAZING, WEATHERSTRIPPING, SOUND AND SMOKE GASKETING, KICK, MOP AND ARMOR PLATES, CORNER GUARDS, CLOSERS (TDC96) AND ELECTRIC LOCKING OR UNLATCHING.

PHOTOGRAPHS OF ALL SHIPMENTS ARE AVAILABLE TO THE CUSTOMER TO SHOW CONDITION OF DOORS AND PACKAGING WHEN SHIPPED FROM FACTORY.

