

1" MIN. CLEARANCE REQUIRED FROM CEILING OR TOP OF POCKET TO FRAME RABBET

12" 16 GA STEEL REINFORCEMENT OR WOOD BLOCKING IN WALL BY G.C. TO RUN FULL WIDTH OF POCKET AND TO TOP OF FRAME

EXIT DEVICE

PULL SIDE HARDWARE

TOTAL DOOR SHOWN IN CLOSED POSITION

STD. UNDERCUT 3/4" CONCRETE SLAB

BY G.C.

JUNCTION BOX ONLY REQUIRED FOR TDH 200 MAG LOCATED 5" FROM END OF POCKET AND 2-1/2" FROM TOP OF DOOR

DOOR POCKET

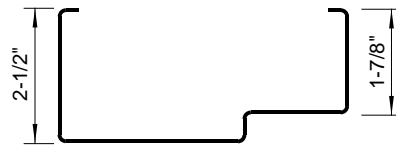

HEAD DETAIL

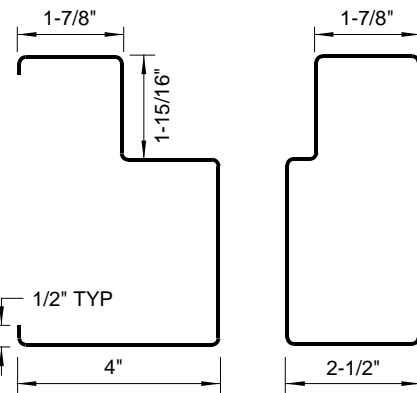

JAMB PROFILE

NOTE: FRAME BY OTHERS

1

VERTICAL SECTION

NOT TO SCALE

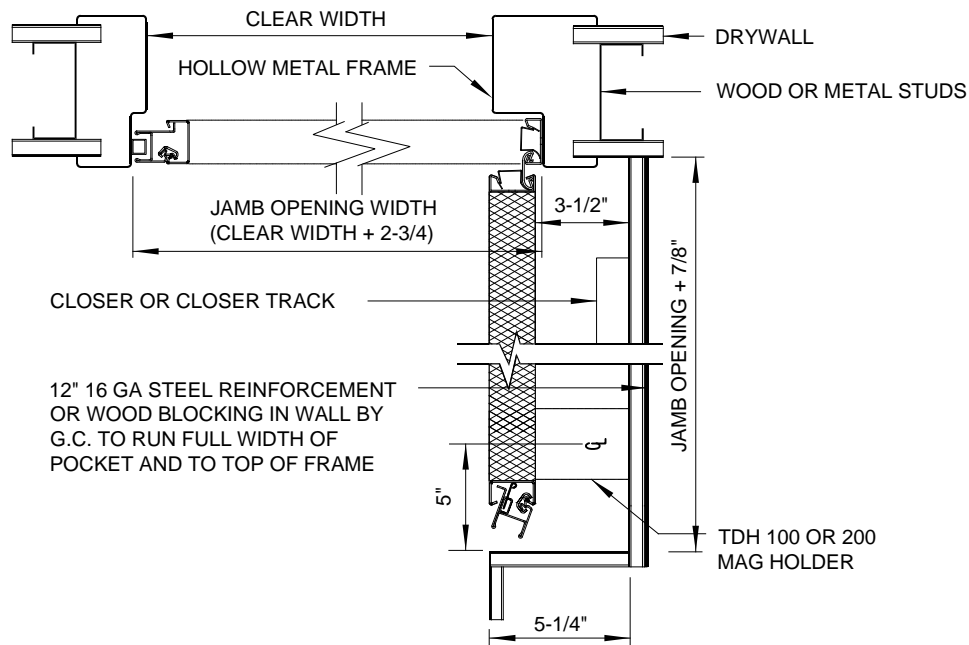

2

HORIZONTAL SECTION

NOT TO SCALE