

# INSTALLATION INSTRUCTIONS FOR FLUSH PANIC – LEVER/CYLINDER

## To Remove Flush Panic Bar

With the door in the open position, depress the retainer at the top of the door and rotate the locking channel into the latched position.

1. Remove the top screw from the end cap at the latch edge of the door only.
2. Pull the panic bar out far enough so that the bottom screw clears the face of the door, then remove the second screw.
3. Pull the bar out until it clears the door face, lift the bar upward and remove it from the door body. (end cap should stay in place)

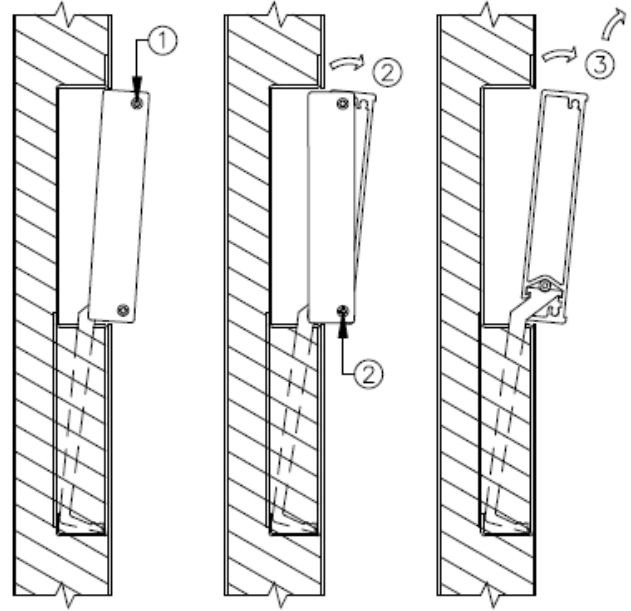

## For Lever Installation

1. Seat lever into escutcheon.
2. Insert Philips Head screwdriver through plug and tighten screw in lever spindle. Screw must be set tightly to avoid loosening.
3. Reinstall panic bar in opposite from instructions above.



## For Cylinder Installation

1. Loosen all 4 bolts in the back plate (top 2 more) enough to tilt mechanism out to allow for clear view of set screws on side of mechanism.
2. Loosen set screws then screw in cylinder. Make certain cam leg points towards the top of the mechanism when key is removed and re-tighten set screws against cylinder.
3. Re-tighten all 4 bolts in the back plate. (make sure mechanism cam is in place)
4. Re-install panic bar in opposite from instructions above.

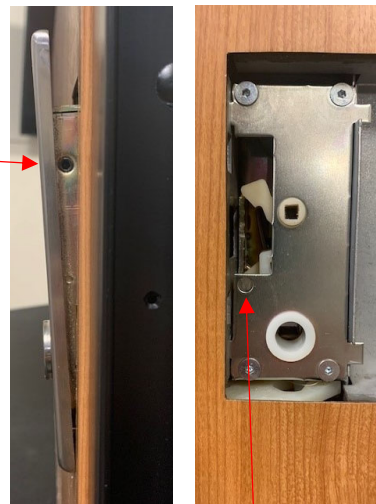

**NOTE:** Recommend hand tools only